

AVAILABLE OPTIONS

- Alternator bracket
- Power steering bracket
- Power steering delete bracket
- Bullet bypass valve kit
- High performance 1,000 hp electric fuel pump
- Crank Pin Kit
- Low profile carb bonnet
- Standard carb bonnet
- Competition carb bonnet
- 12-Rib Upgrade
- Polished finish (ProCharger, bracket and carb bonnet)

LSx FOOTNOTES

- 1) 1966-72 A body (Chevelle, GT0, ect.)
1968-72 Nova
1968-81 Camaro/Firebird
Fitment into the listed vehicles confirmed. Variability of chassis and aftermarket components may require modifications
- 2) Specify with or without power steering when using ProCharger Accessory Brackets; GM power steering pump #15261472 (or others) (sold separately by others)
- 3) Alternator bracket compatible with: GM alternator: #25888970 (or others) (sold separately by others)
- 4) Alternator bracket compatible with: GM tensioner: #12569301 (or others) (sold separately by others)
- 5) Compatible with: GM air conditioning bracket: #92175482; GM air conditioning compressor: #92067713; GM air conditioning belt: #25-040430 (or others) (sold separately by others)
- 6) Pinning of the crank pulley is recommended
- 7) Compatible with mechanical or electric water pump
- 8) Designed to work with Muscle Rods motor mounts (application dependent) (or others), (sold separately by others)
- 9) Intercooled kits contain "universal components", customization required

Note: Factory-style EFI intake shown; Serpentine Drive Supercharger Kits are compatible with aftermarket EFI or carburetor-equipped LSx engines

NEW! ProCharger Serpentine Drive Supercharger Kits for LSx Engines

KIT DIMENSIONS

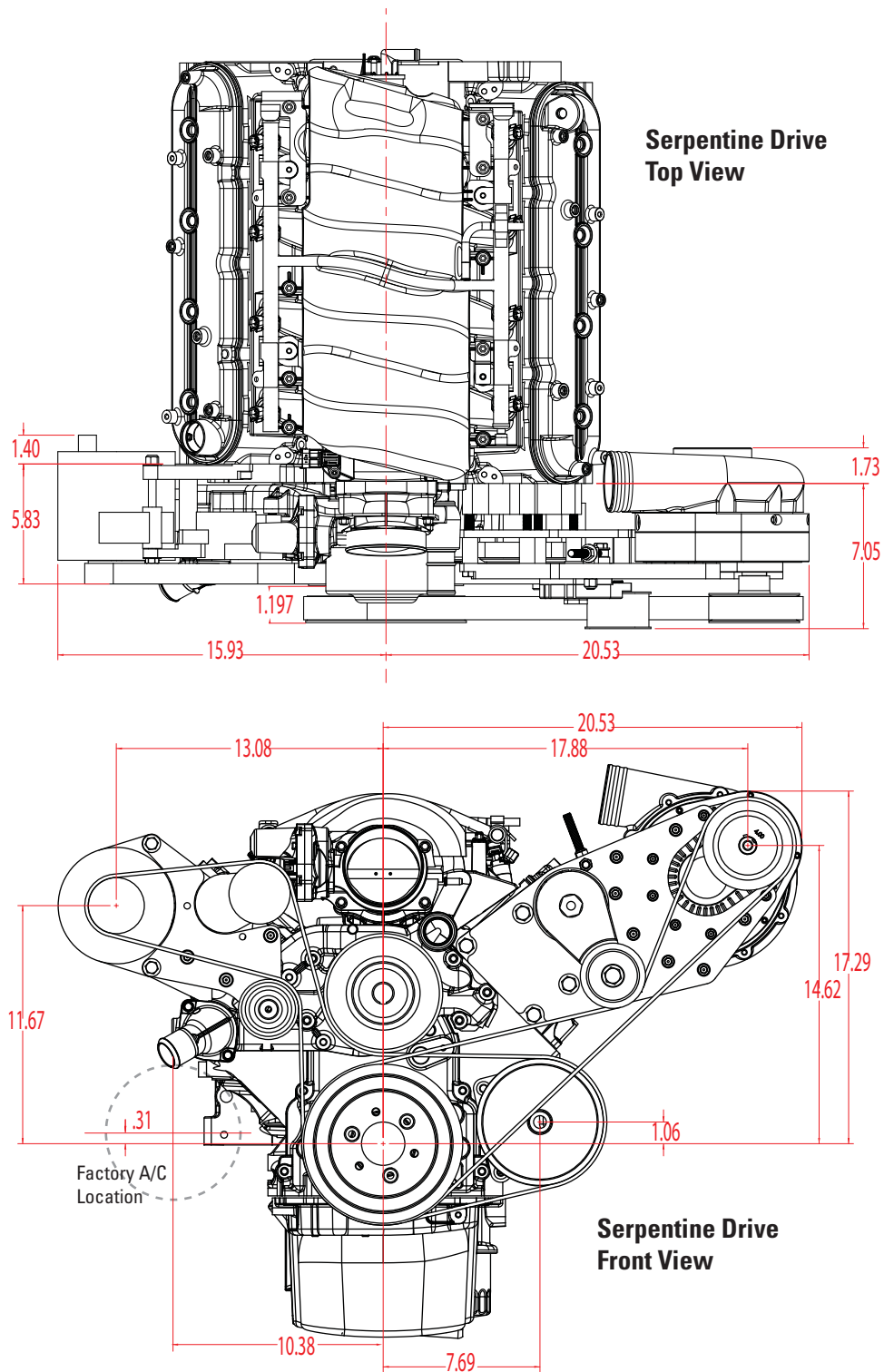

Additional ProCharger LS brackets available – Call for options



14801 W. 114th Terrace, Lenexa KS 66215
PH: 913.338.2886 • FX: 913.338.2879 • www.ProCharger.com

